

## APPENDIX A: ILLUSTRATIONS

### Section

1. Floor area terminology
2. Floor area ratio (FAR)
3. Building height requirements
4. Corner, interior, and double frontage lots
5. Nonconforming use
6. Yard requirements
7. Basement and story illustration
8. Basic structural terms
9. Lot terms
10. Fences
11. Required side yards for selected corner lots widths
12. Off-street parking diagram
13. Parking islands

§ 1. FLOOR AREA TERMINOLOGY.

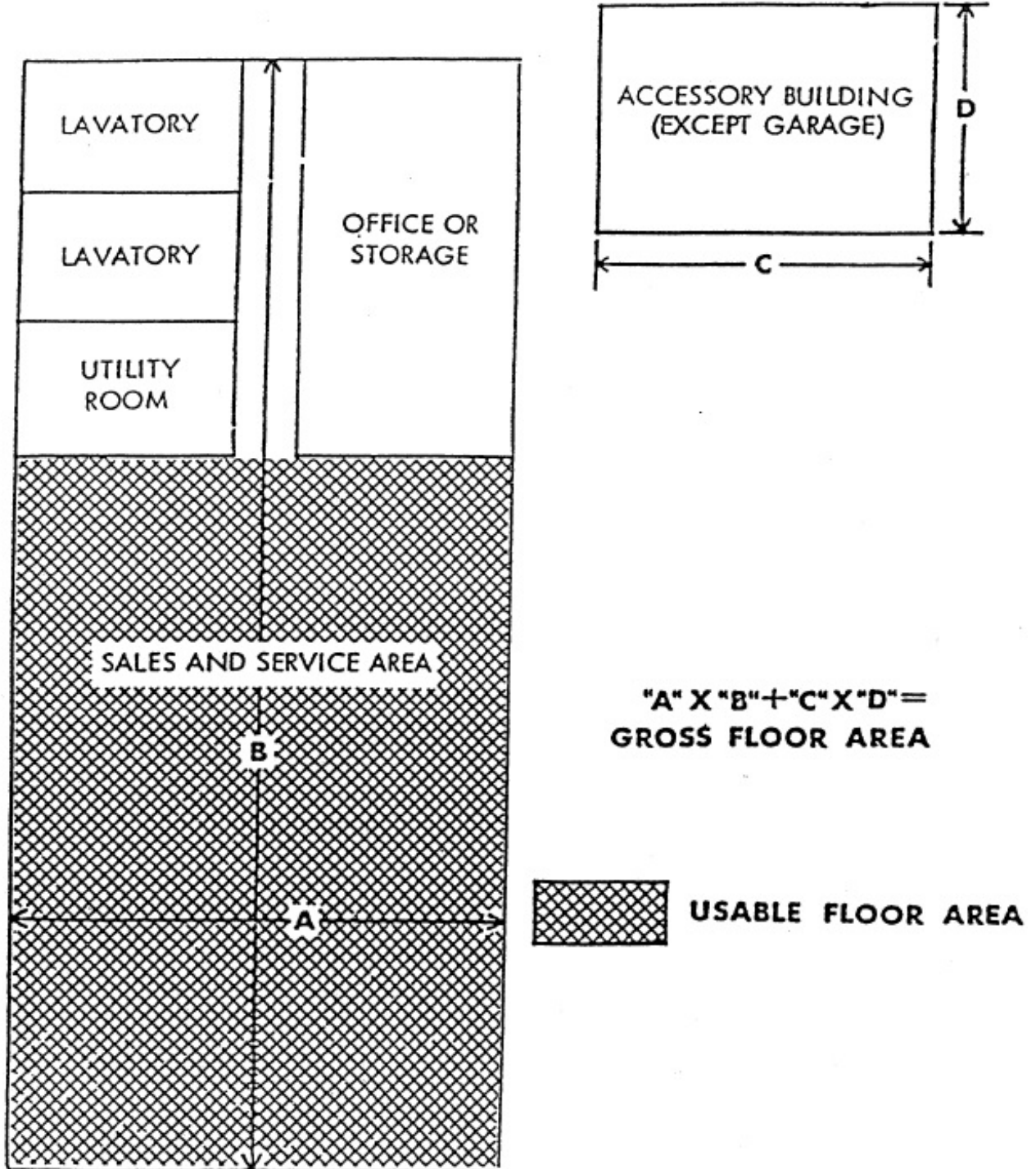

(Prior Code, Ch. 153, App. § 1) (Ord. D-1418, passed 11-22-1982, effective 1-21-1983)

§ 2. FLOOR AREA RATIO (FAR).

FORMULA

$$\frac{\text{GROSS FLOOR AREA}}{\text{LOT AREA}} = \text{FAR}$$

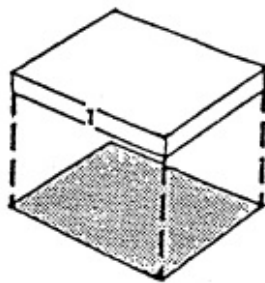

100%

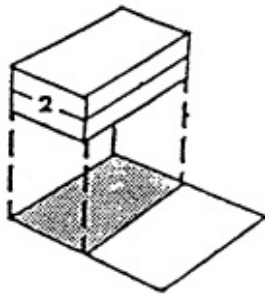

50%

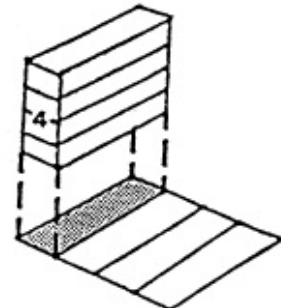

25%

FAR = 1

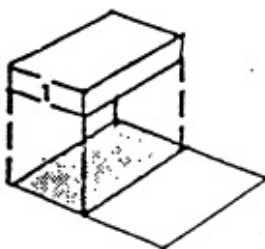

50%

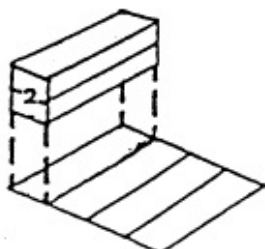

25%

FAR = 0.5

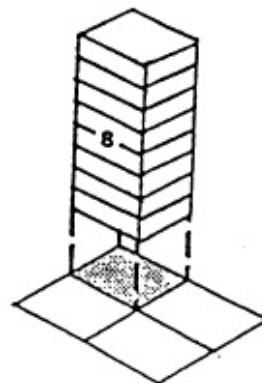

25%

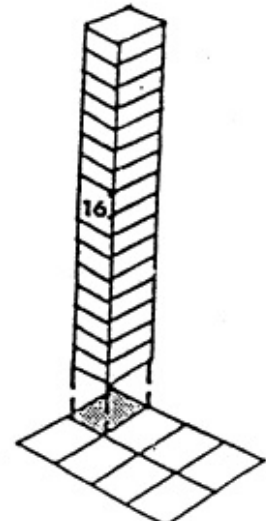

12½%

FAR = 2

(Prior Code, Ch. 153, App. § 2) (Ord. D-1418, passed 11-22-1982, effective 1-21-1983)

§ 3. BUILDING HEIGHT REQUIREMENTS.

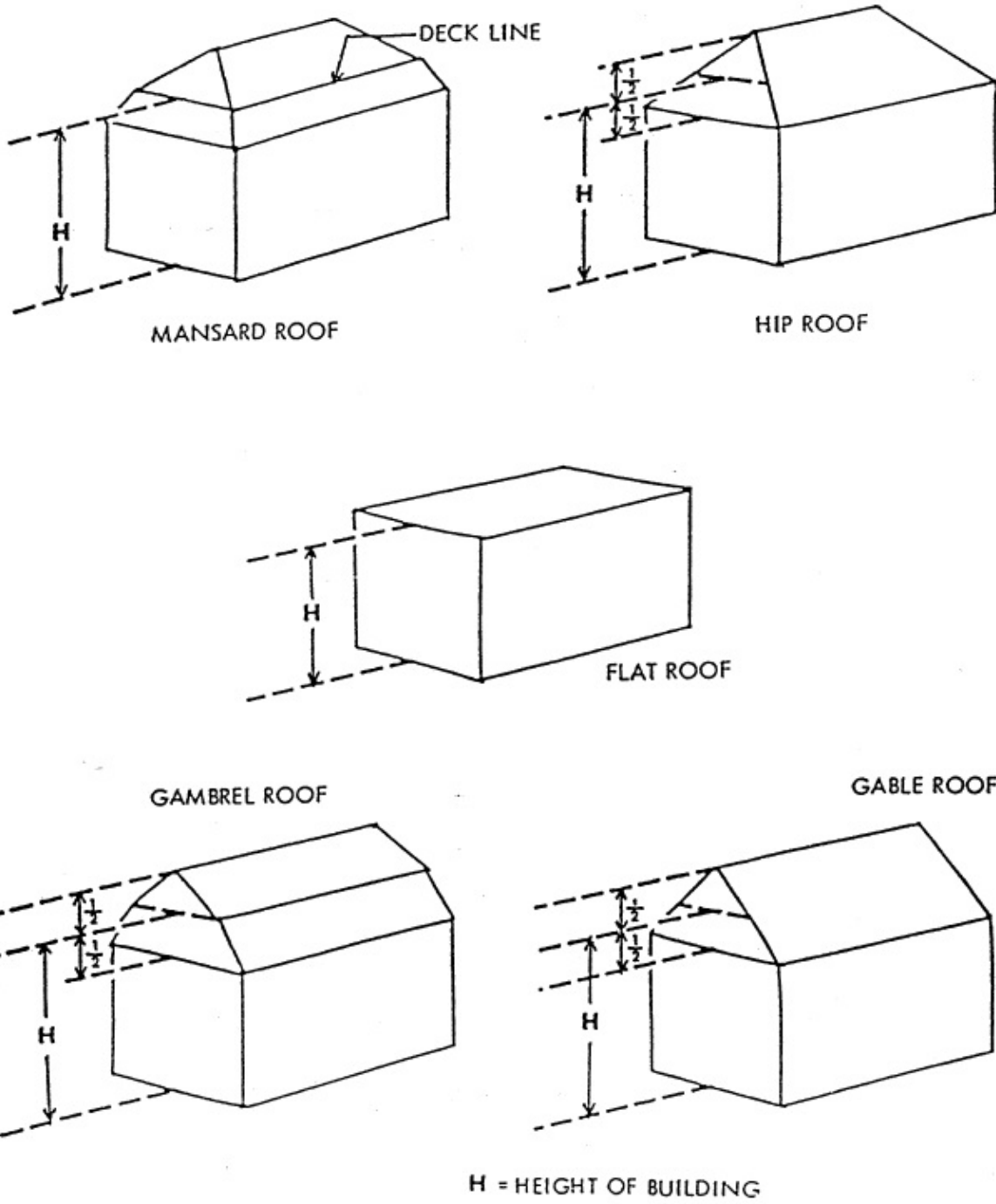

(Prior Code, Ch. 153, App. § 3) (Ord. D-1418, passed 11-22-1982, effective 1-21-1983)

§ 4. CORNER, INTERIOR, AND DOUBLE FRONTAGE LOTS.

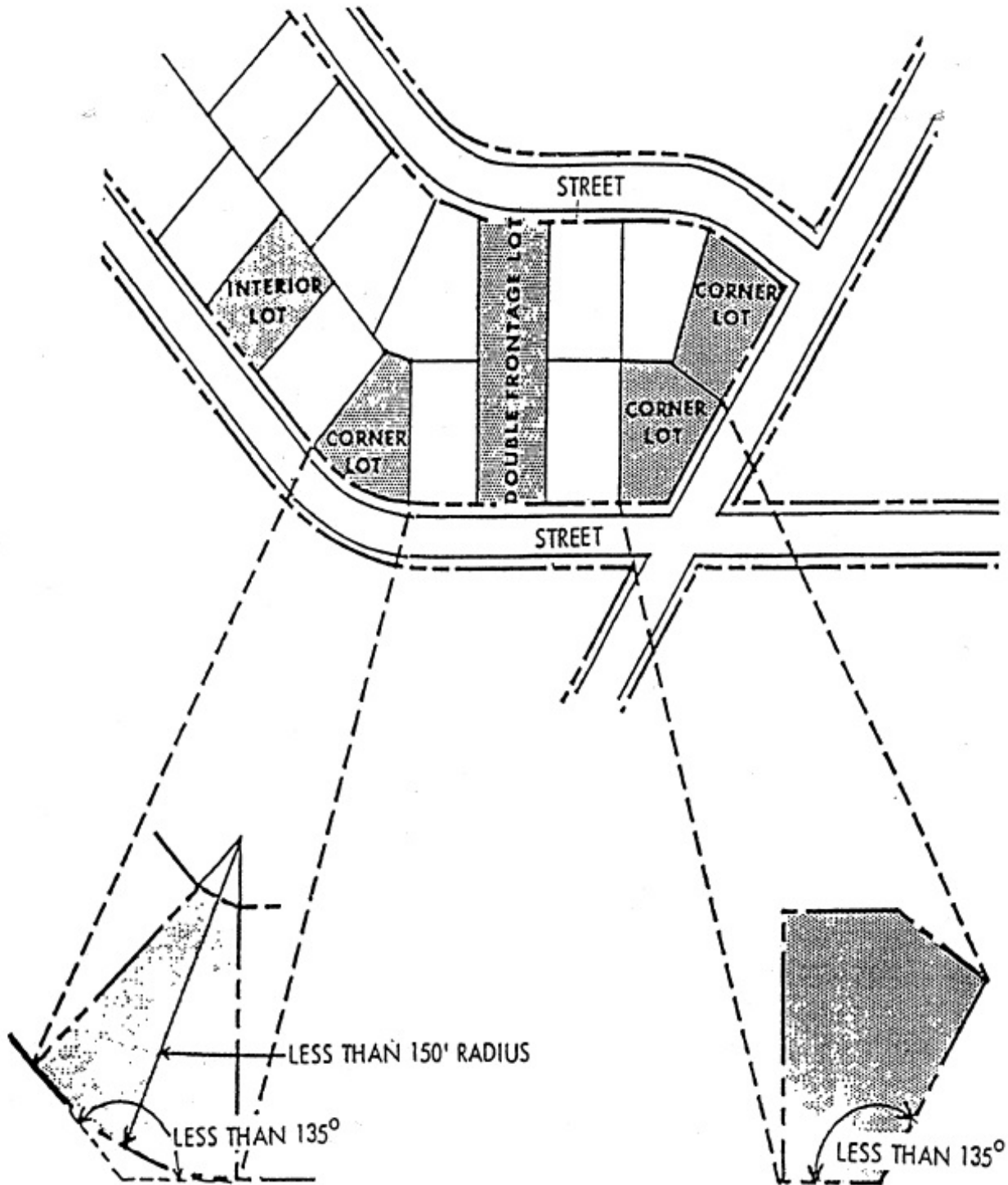

(Prior Code, Ch. 153, App. § 4) (Ord. D-1418, passed 11-22-1982, effective 1-21-1983)

§ 5. NONCONFORMING USE.

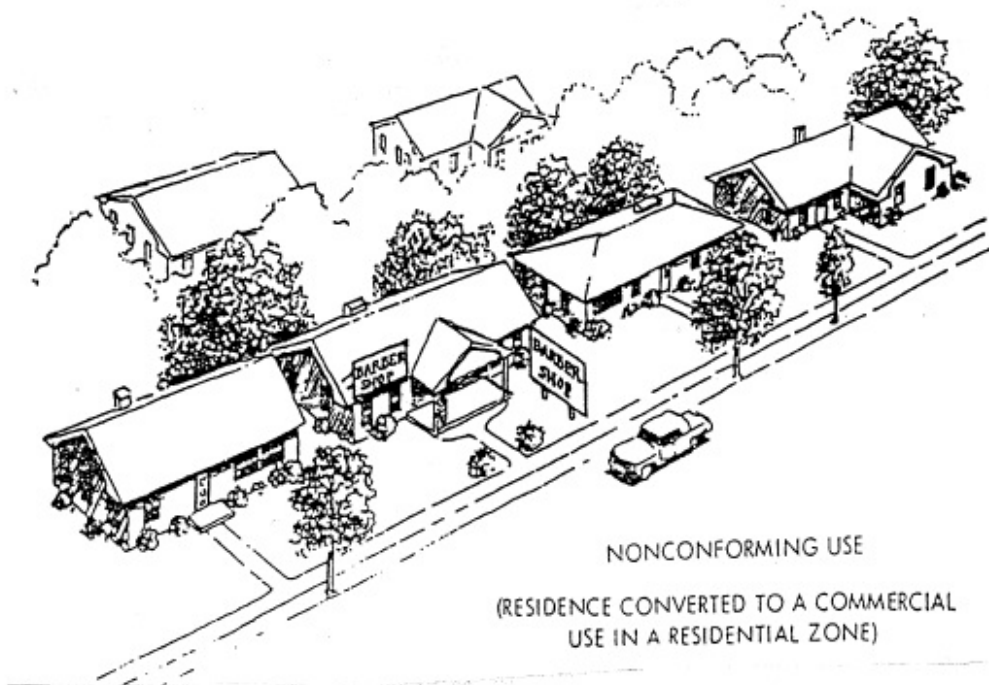
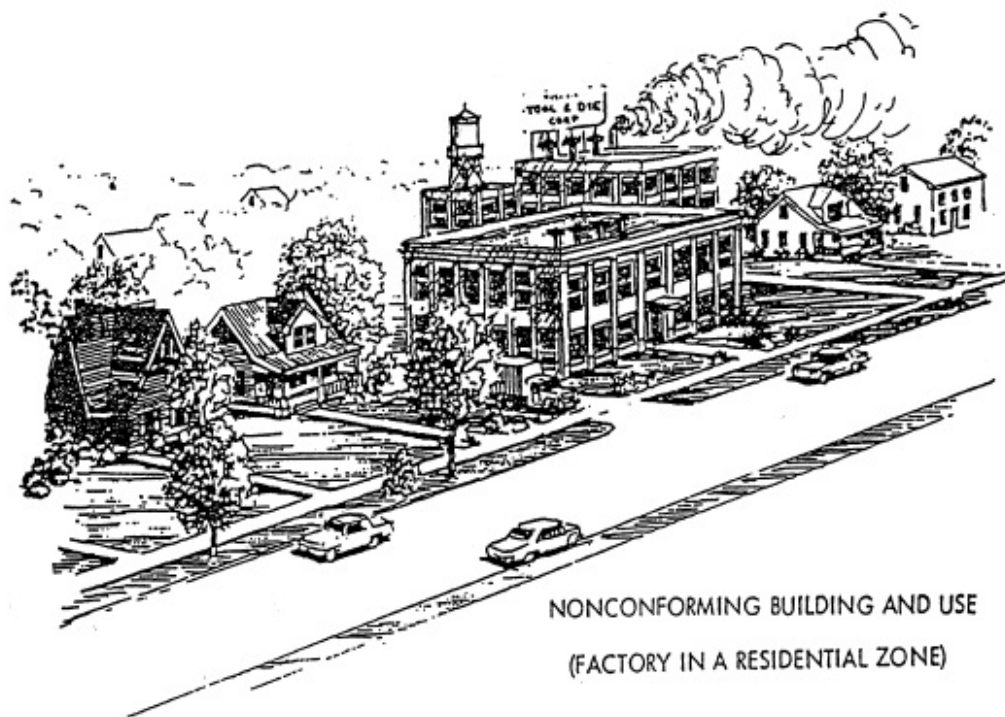

(Prior Code, Ch. 153, App. § 5) (Ord. D-1418, passed 11-22-1982, effective 1-21-1983)

§ 6. YARD REQUIREMENTS.

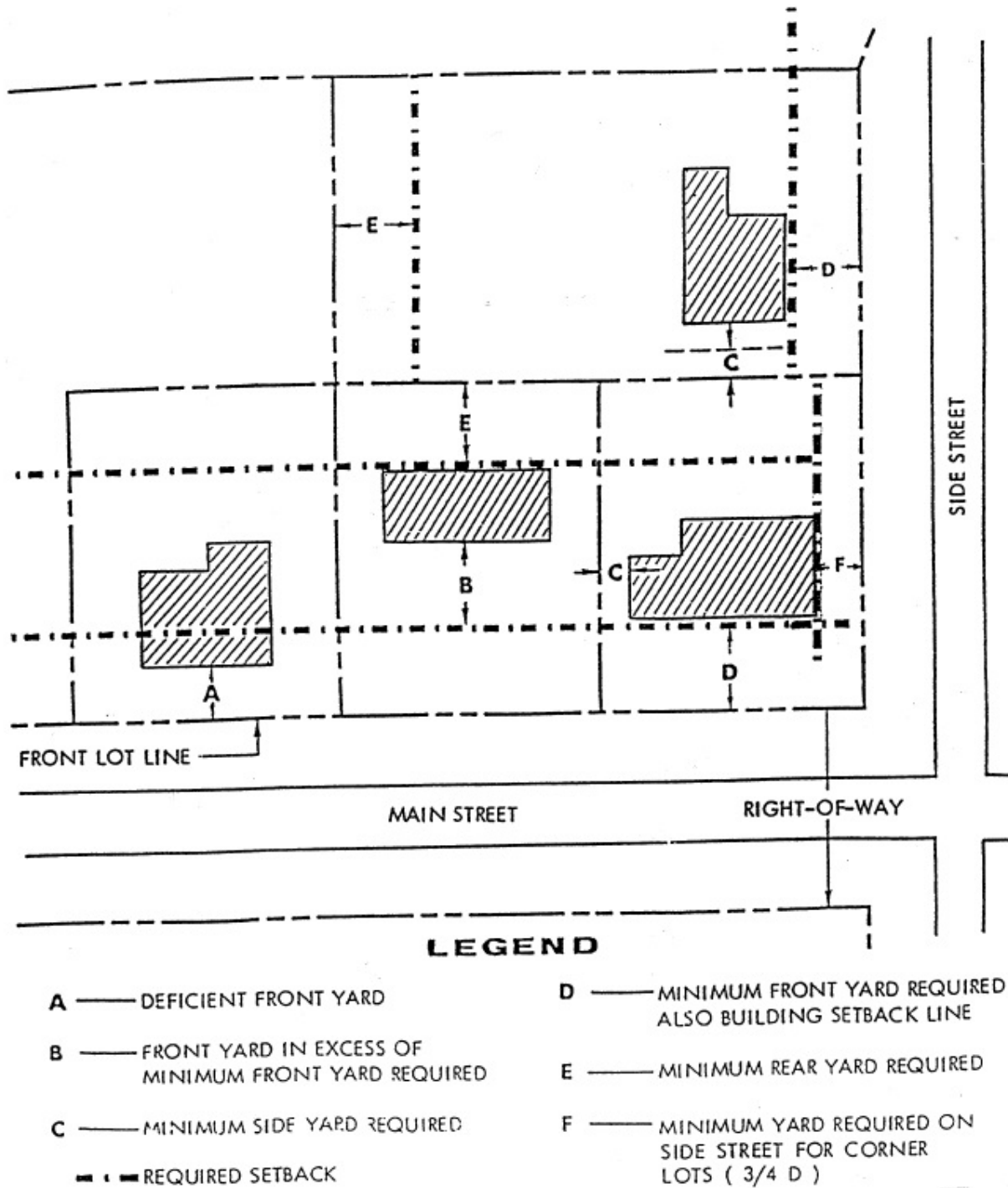

(Prior Code, Ch. 153, App. § 6) (Ord. D-1418, passed 11-22-1982, effective 1-21-1983)

§ 7. BASEMENT AND STORY ILLUSTRATION.

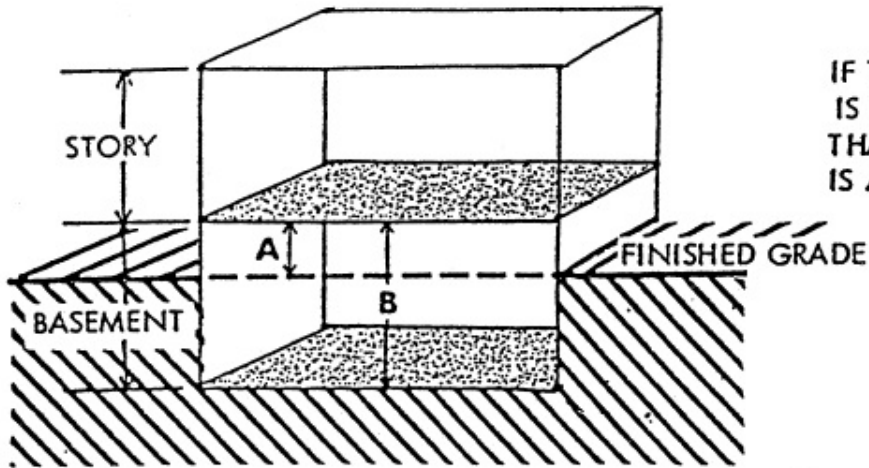

IF THE AVERAGE OF "A" IS EQUAL TO OR LESS THAN 1/2 OF "B", THIS IS A BASEMENT.

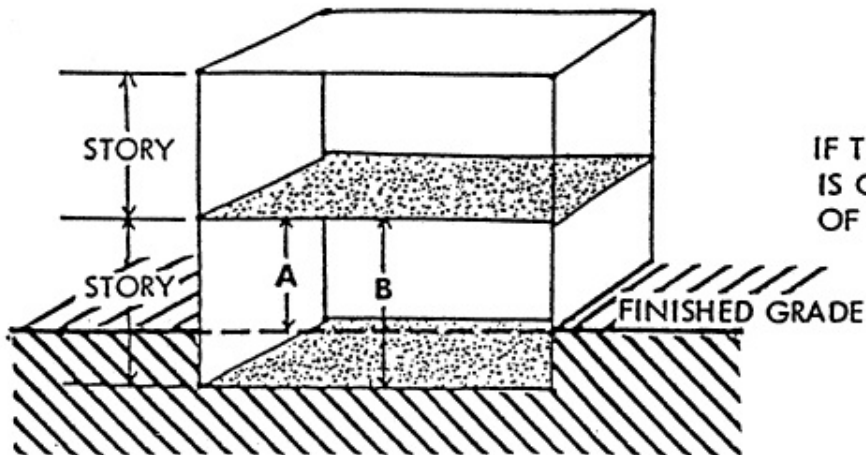

IF THE AVERAGE OF "A" IS GREATER THAN 1/2 OF "B", THIS IS A STORY.

(Prior Code, Ch. 153, App. § 7) (Ord. D-1418, passed 11-22-1982, effective 1-21-1983)



§ 8. BASIC STRUCTURAL TERMS.

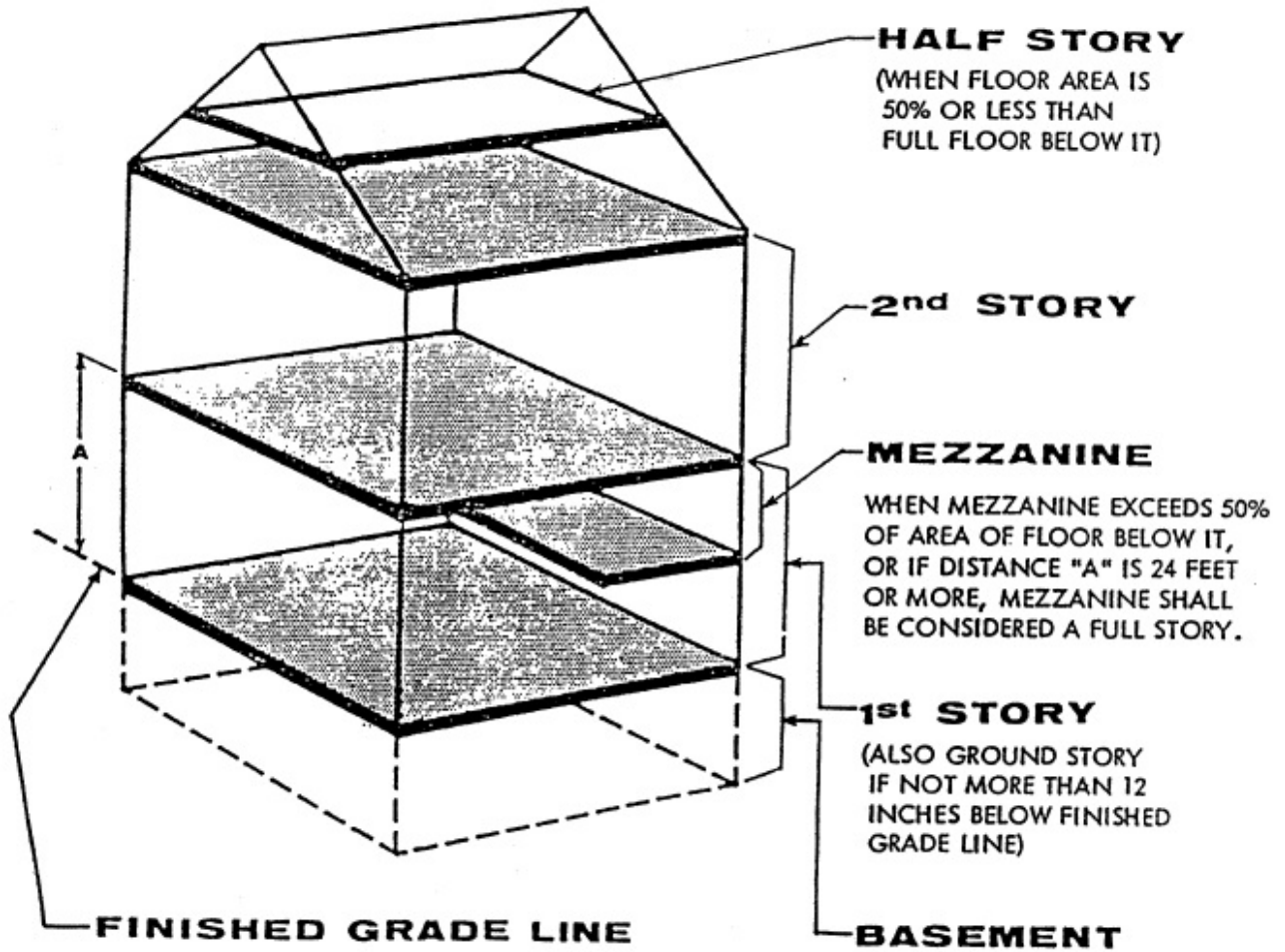

(Prior Code, Ch. 153, App. § 8) (Ord. D-1418, passed 11-22-1982, effective 1-21-1983)

§ 9. LOT TERMS.

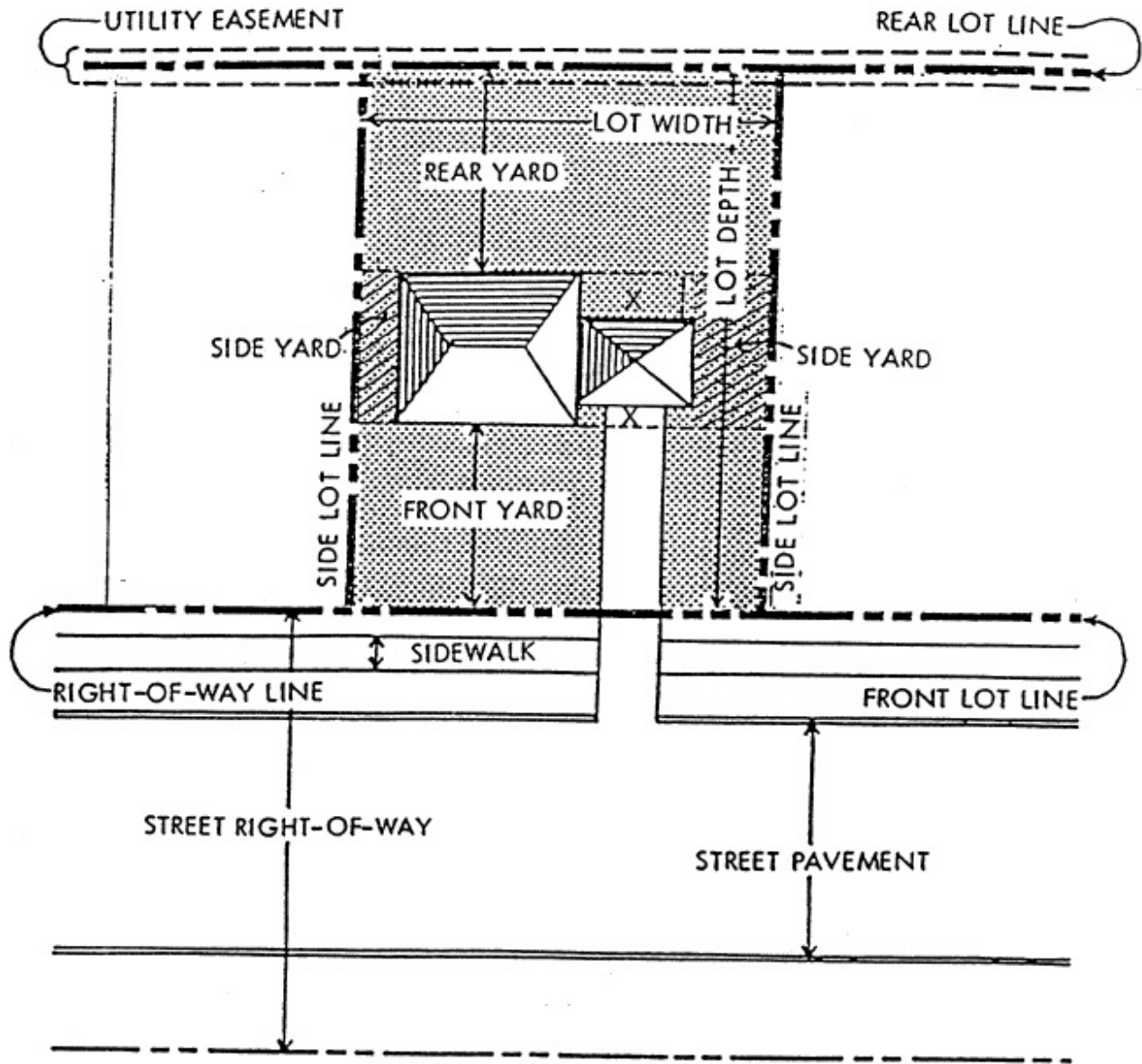

(Prior Code, Ch. 153, App. § 9) (Ord. D-1418, passed 11-22-1982, effective 1-21-1983)

§ 10. FENCES.

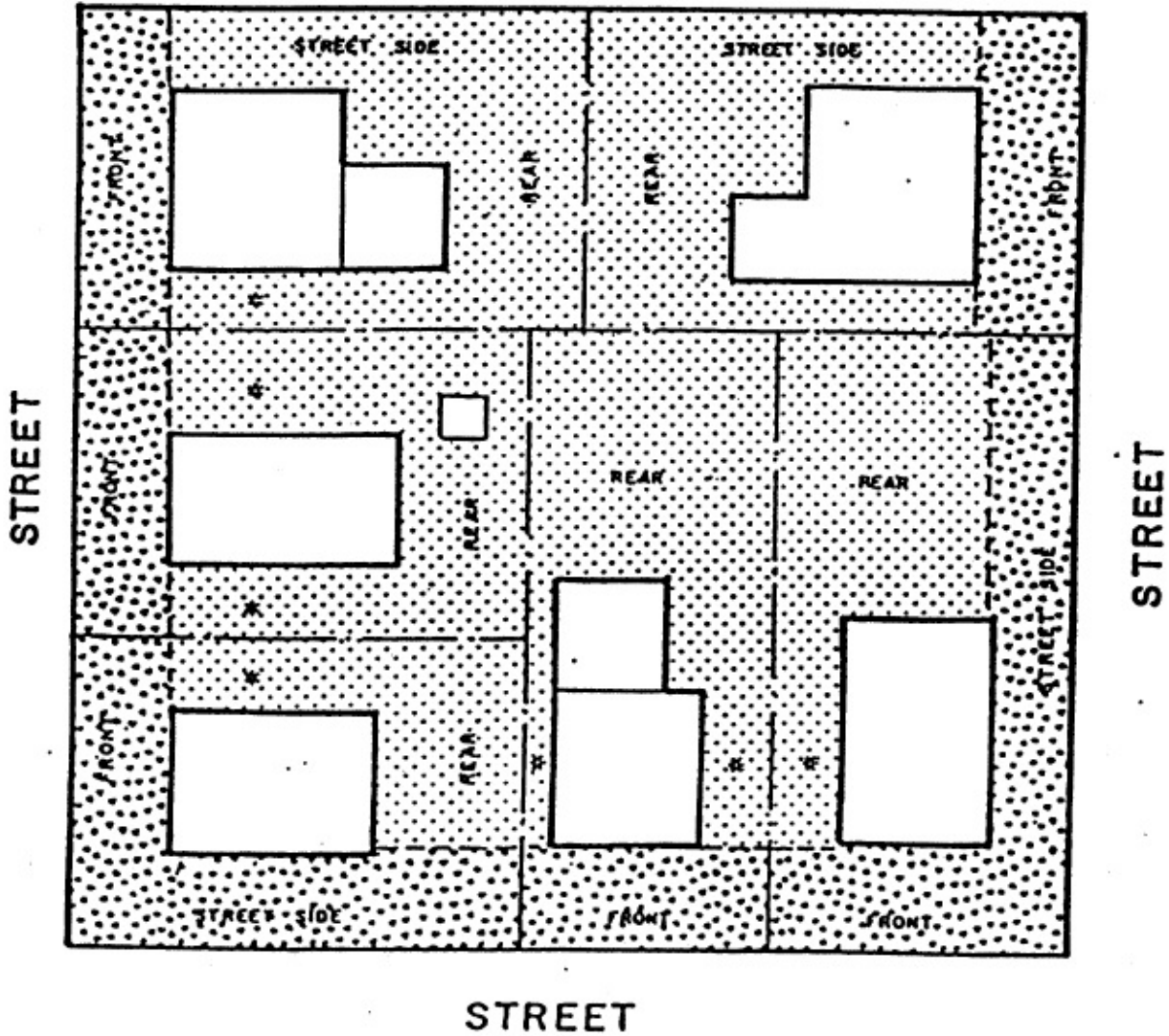

MAXIMUM HEIGHT 4'  
 Open Construction (see also requirements for clear vision areas on corner lots and driveways.)

MAXIMUM HEIGHT 6'  
 Open or Closed Construction.

\* FENCES LESS THAN 5 FEET FROM A WINDOW OR DOOR (EXCEPT BASEMENT WINDOW) OF AN ABUTTING DWELLING MUST BE 4 FEET TALL IF OF CLOSED CONSTRUCTION.

(Prior Code, Ch. 153, App. § 10) (Ord. D-1418, passed 11-22-1982, effective 1-21-1983)

§ 11. REQUIRED SIDE YARDS FOR SELECTED CORNER LOTS WIDTHS.

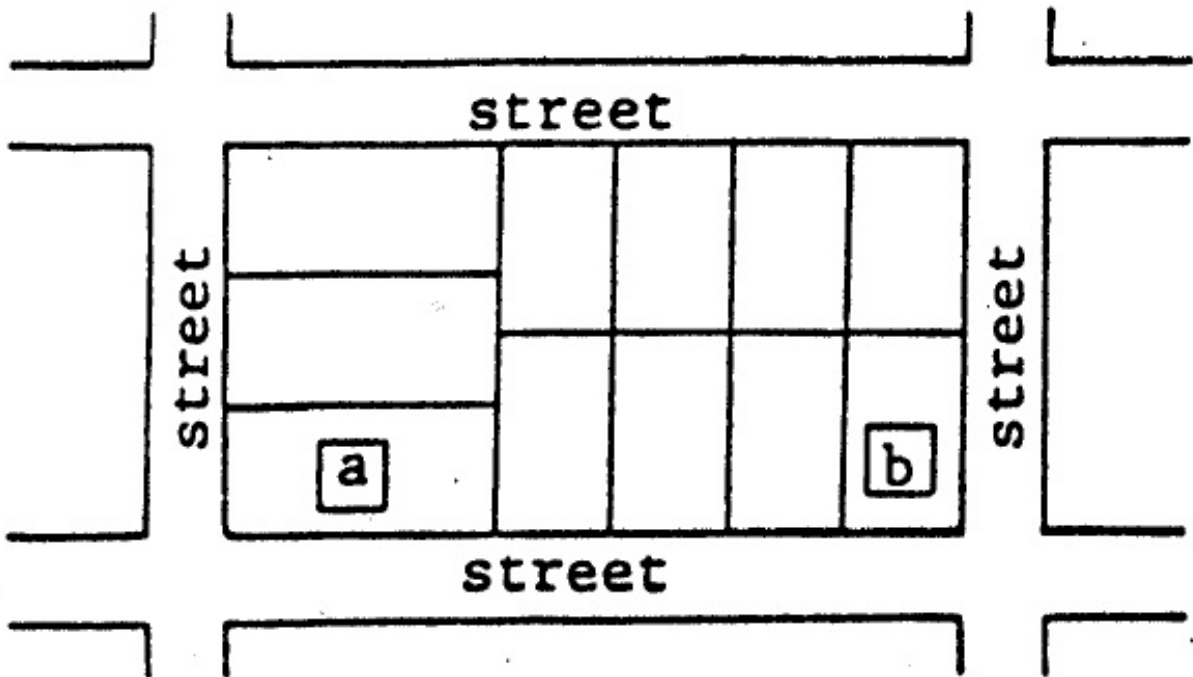

(Prior Code, Ch. 153, App. § 11) (Ord. D-1418, passed 11-22-1982, effective 1-21-1983)

§ 12. OFF-STREET PARKING DIAGRAM.

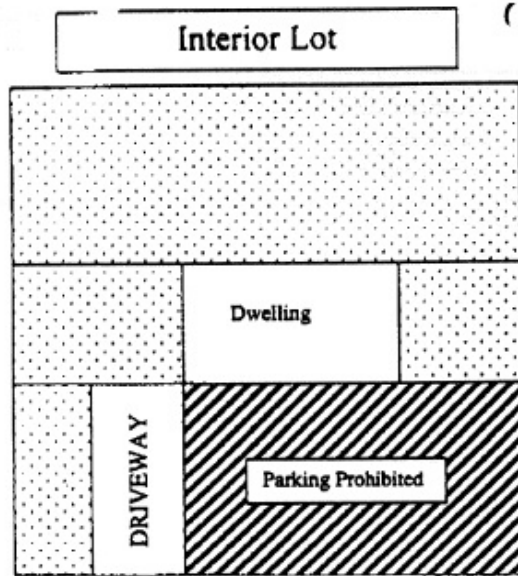

STREET  
FIGURE 6.1

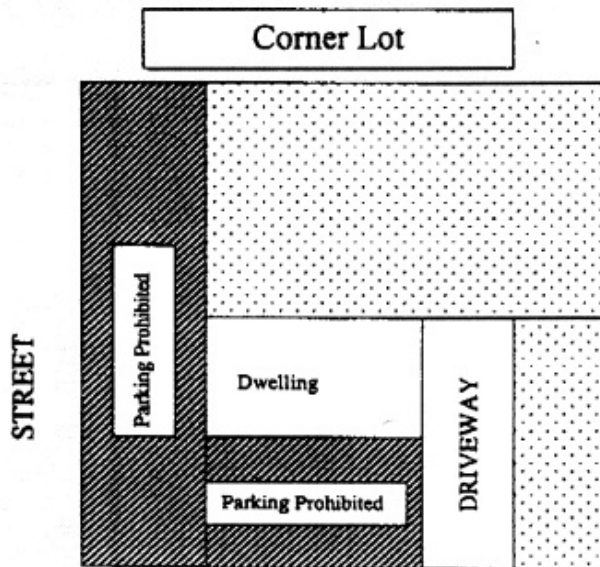
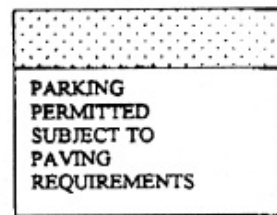

STREET  
FIGURE 6.2

(Prior Code, Ch. 153, App. § 12) (Ord. D-1887, passed 2-19-2001, effective 3-1-2001)

§ 13. PARKING ISLANDS.

**SECTION 601 (S) Parking Islands**

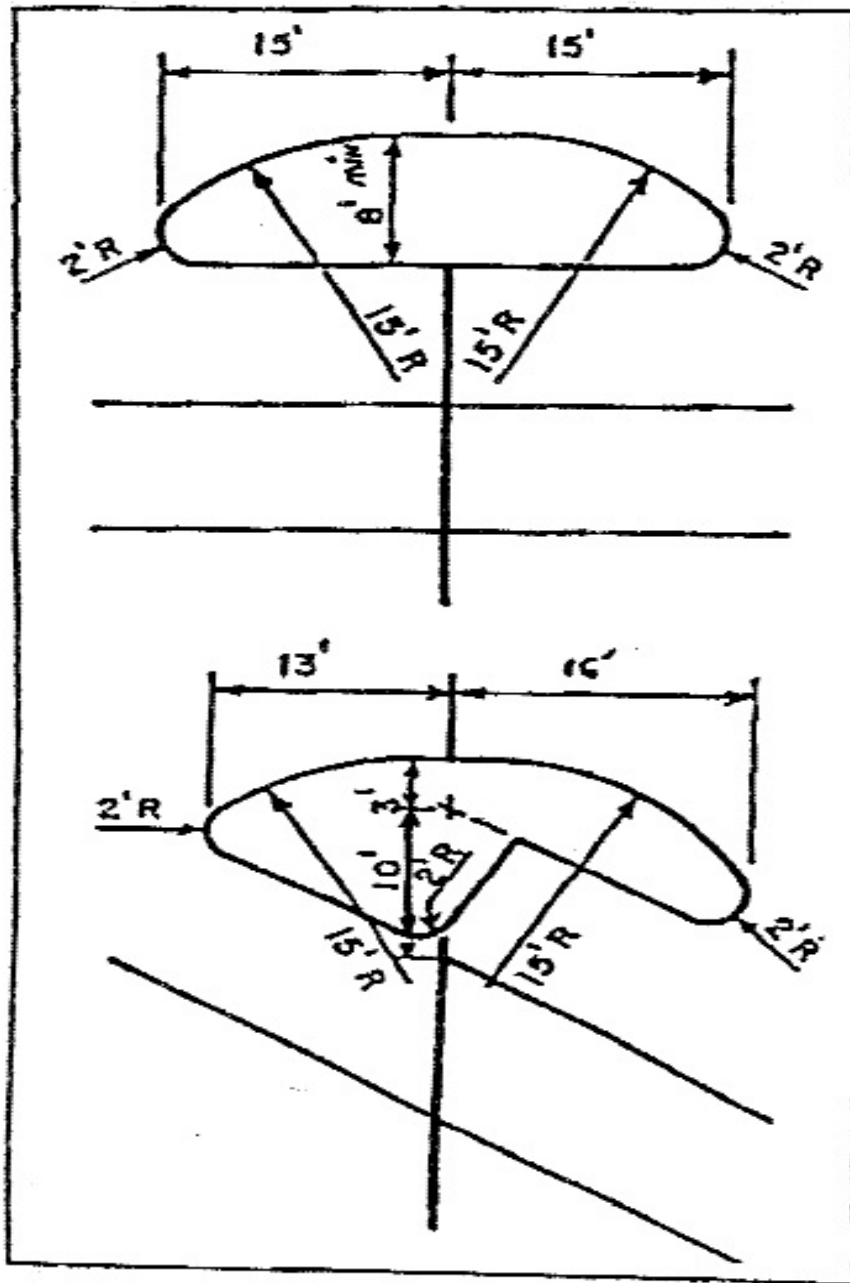

(Prior Code, Ch. 153, App. § 13) (Ord. D-1887, passed 2-19-2001, effective 3-1-2001)