

NOTES

1. Thrust Side Of Blocking Shall Be Placed Against Firm, Undisturbed Earth.

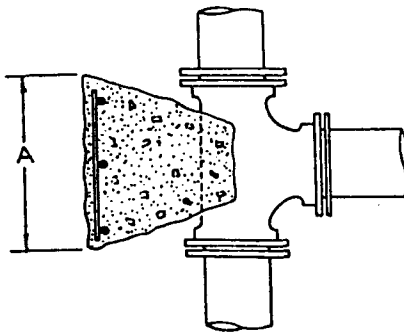

PLAN

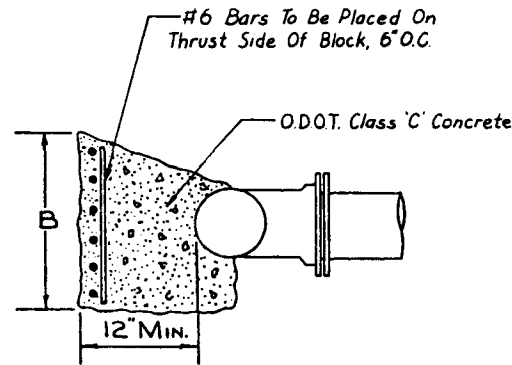

SECTION

SIZE		75 P.S.I. & UNDER				75 TO 125 P.S.I.				125 TO 200 P.S.I.			
RUN	BRANCH	A	B	CU. YDS. CONC.	LBS. STEEL	A	B	CU. YDS. CONC.	LBS. STEEL	A	B	CU. YDS. CONC.	LBS. STEEL
6	6	1'6"	1'6"	0.1	14	2'0"	1'6"	0.1	20	2'0"	2'0"	0.2	21
8	6	1'6"	1'6"	0.1	14	2'0"	1'9"	0.1	20	2'0"	2'0"	0.2	21
12	6	1'6"	1'6"	0.1	14	2'0"	2'0"	0.2	25	2'0"	2'0"	0.2	21
16	6	1'6"	1'6"	0.1	14	2'0"	2'3"	0.2	25	2'0"	2'0"	0.2	21
20	6	1'6"	1'6"	0.1	14	2'0"	2'6"	0.3	30	2'0"	2'0"	0.2	21
8	8	2'0"	2'0"	0.2	24	2'6"	2'0"	0.2	28	3'-0"	2'-3"	0.2	32
10	8	2'0"	2'0"	0.2	24	2'6"	2'0"	0.2	28	3'-0"	2'-3"	0.2	32
12	8	2'0"	2'0"	0.2	24	2'6"	2'0"	0.2	28	3'-0"	2'-3"	0.3	32
16	8	2'0"	2'0"	0.2	24	2'6"	2'6"	0.3	35	3'-0"	2'-4"	0.3	32
20	8	2'0"	2'0"	0.2	24	2'6"	2'9"	0.4	35	3'-0"	2'-9"	0.4	39
12	12	3'0"	3'0"	0.5	54	4'0"	2'6"	0.4	55	4'6"	3'6"	0.7	95
16	12	3'0"	3'0"	0.5	54	4'0"	2'6"	0.4	55	4'6"	3'9"	0.7	98
20	12	3'0"	3'0"	0.5	54	4'0"	2'9"	0.6	60	4'6"	4'0"	1.0	108
20	16	4'0"	3'6"	0.8	84	4'6"	4'0"	1.0	108	6'0"	5'0"	1.5	180
20	20	4'6"	4'6"	1.1	122	5'6"	5'0"	1.4	165	7'0"	6'0"	2.0	252

8-0

CITY OF ELYRIA, OHIO ENGINEERING DEPARTMENT	
TYPICAL BLOCKING FOR CAST IRON TEES	
DR. BY <u>TJS</u> DATE <u>2-77</u>	DRAWING
CK. BY <u>P.A.</u> DATE <u>2-12-77</u>	
BY _____ DATE _____	2-202
REVISIONS	
APPROVED CITY ENGINEER <i>Lenny A. Rupp</i>	