

PLAN VIEW

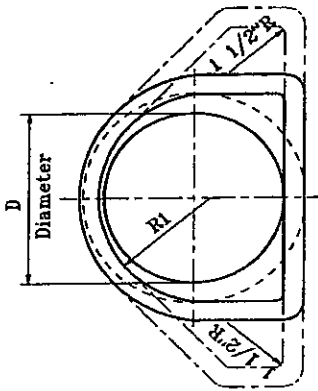

SECTION Y-Y

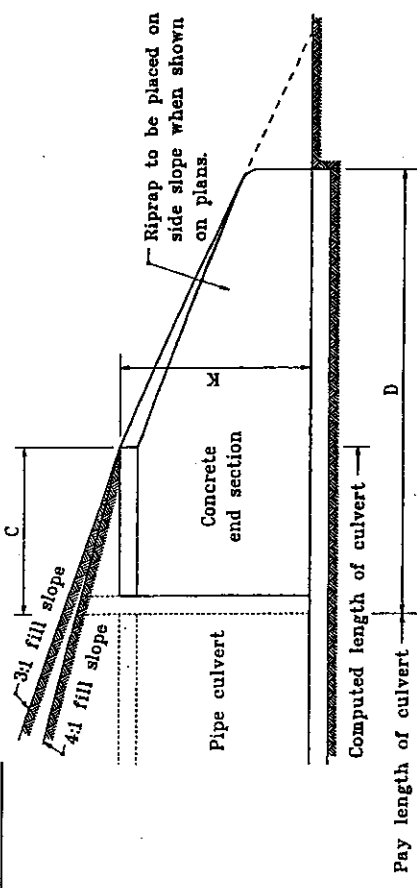

SLOPE DETAIL

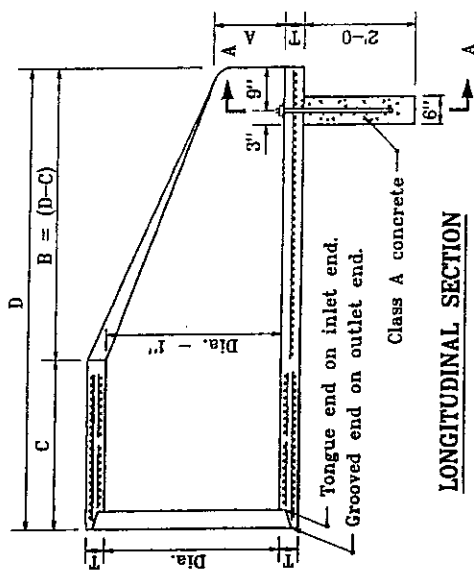

LONGITUDINAL SECTION

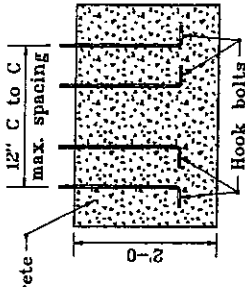

SECTION A-A

Concrete Pipe Toe Anchor

TABLE OF DIMENSIONS

DIA.	T (min.)	A (±1")	C (±1")	D (±1")	E (±1")	K	R1	R2	APPROX. WEIGHT, lb.
12"	2"	5"	4'-3"	6'-2"	2'-0"	1.3	10 1/2"	9"	800
15"	2 1/2"	7"	4'-0"	6'-3"	2'-6"	1.5	12 1/2"	11"	1100
18"	2 3/4"	11"	4'-1"	6'-2"	3'-0"	1.8	15 1/2"	12"	1300
21"	2 3/4"	11"	3'-6"	6'-3"	3'-6"	2.1	16 1/2"	13"	1500
24"	3"	1'-0"	2'-8"	6'-3"	4'-0"	2.3	18 3/8"	14"	1800
27"	3 1/4"	1'-1"	2'-5"	6'-3"	4'-6"	2.6	18 3/8"	14 1/2"	2100
30"	3 1/2"	1'-2"	1'-10"	6'-3"	5'-0"	2.9	18 1/2"	15"	2400
33"	3 3/4"	1'-3"	3'-6"	8'-3"	5'-6"	3.1	23 3/4"	17 1/2"	4100
36"	4"	1'-5"	3'-1"	8'-3"	6'-0"	3.4	24 3/8"	20"	4200

INDIANA DEPARTMENT OF TRANSPORTATION
**PRECAST CONCRETE
END SECTION**
MAY 1939

STANDARD DRAWING NO. E 715-PCES-01

DETAILS PLACED IN THE COMPANY 11-5-39

L. UREKOWICZ
No. 18095
STATE OF INDIANA
PROFESSIONAL ENGINEER

L. Urekowicz 11-5-39
 CHIEF HIGHWAY ENGINEER
 ORIGINALY APPROVED
 DATE 5-0-38