

LONGITUDINAL SAFETY BAR DETAIL

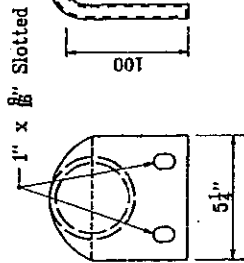

1" x $\frac{3}{8}$ " Slotted



3" galvanized pipe: Flatten end, then bend outside 4" to match end section sides.

OR

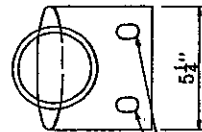

1" x $\frac{3}{8}$ " Slotted

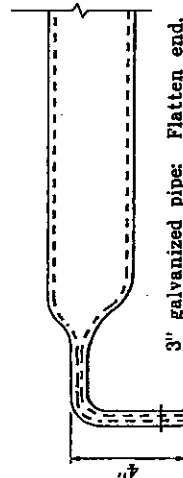

3" galvanized pipe: Flatten end, then bend outside 4" to match end section sides.

TRANSVERSE SAFETY BAR DETAILS

INDIANA DEPARTMENT OF TRANSPORTATION
**SAFETY METAL CULVERT END
 SECTIONS FOR CORRUGATED PIPE**

JANUARY 1980

STANDARD DRAWING NO. E 715-SMES-02

DETAILS PLACED IN THIS FORMAT 7-27-99

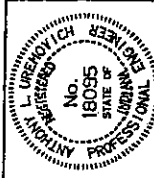

/s/ Anthony L. Urepaucha 7-27-99
 DESIGN ENGINEER DATE

/s/ Eugene Zentel 7-27-99
 CHECKED BY ENGINEER DATE
 ORIGINALLY APPROVED 1-02-98

DESIGN ENGINEER