

APPENDIX: ILLUSTRATIONS AND DIAGRAMS

Section

1. Corner and reverse corner side yards - R-1 One-Family Residence District
2. Corner and reverse corner side yards - R-2 One-Family Residence District
3. Corner and reverse corner side yards - R-3 One-Family Residence District
4. Good vision clearance
5. Example of residential lot types
6. Corner lot diagram
7. Lot types
8. Lot width and lot depth explained
9. Zoning district map

§ 1. CORNER AND REVERSE CORNER SIDE YARDS - R-1 ONE-FAMILY RESIDENCE DISTRICT.

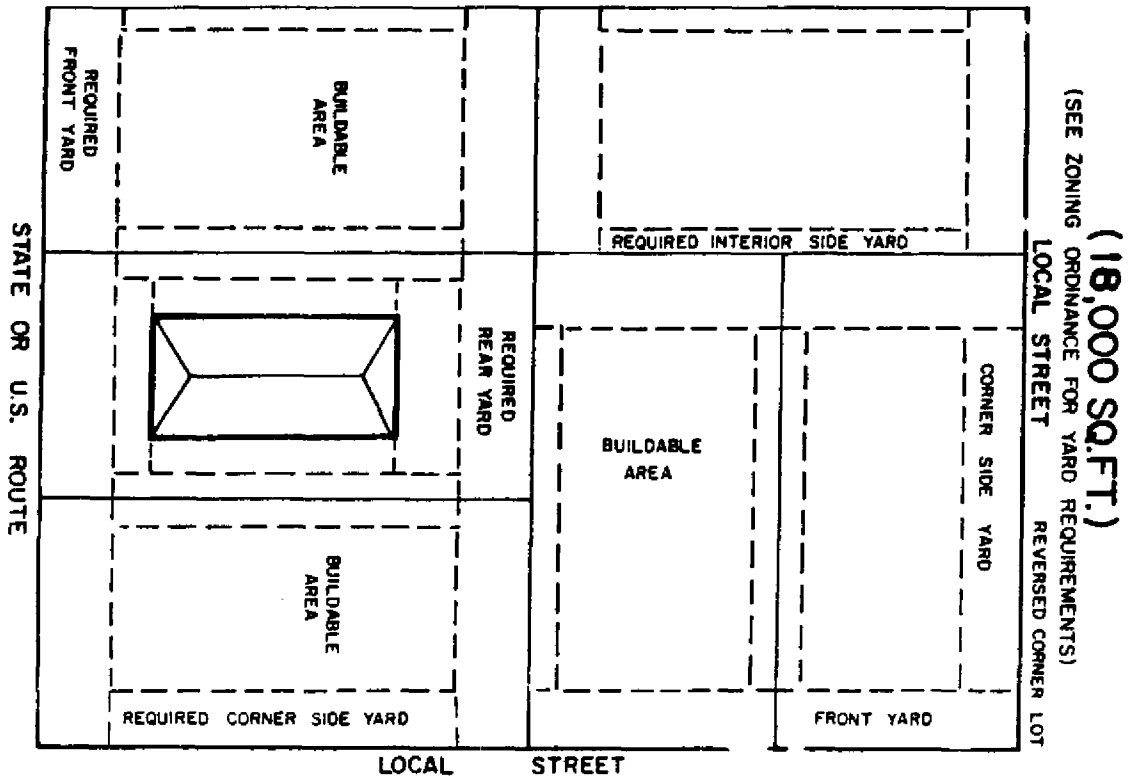

(Ord. 77-08, passed 6-28-77)

§2. CORNER AND REVERSE CORNER SIDE YARDS - R-2 ONE-FAMILY RESIDENCE DISTRICT.

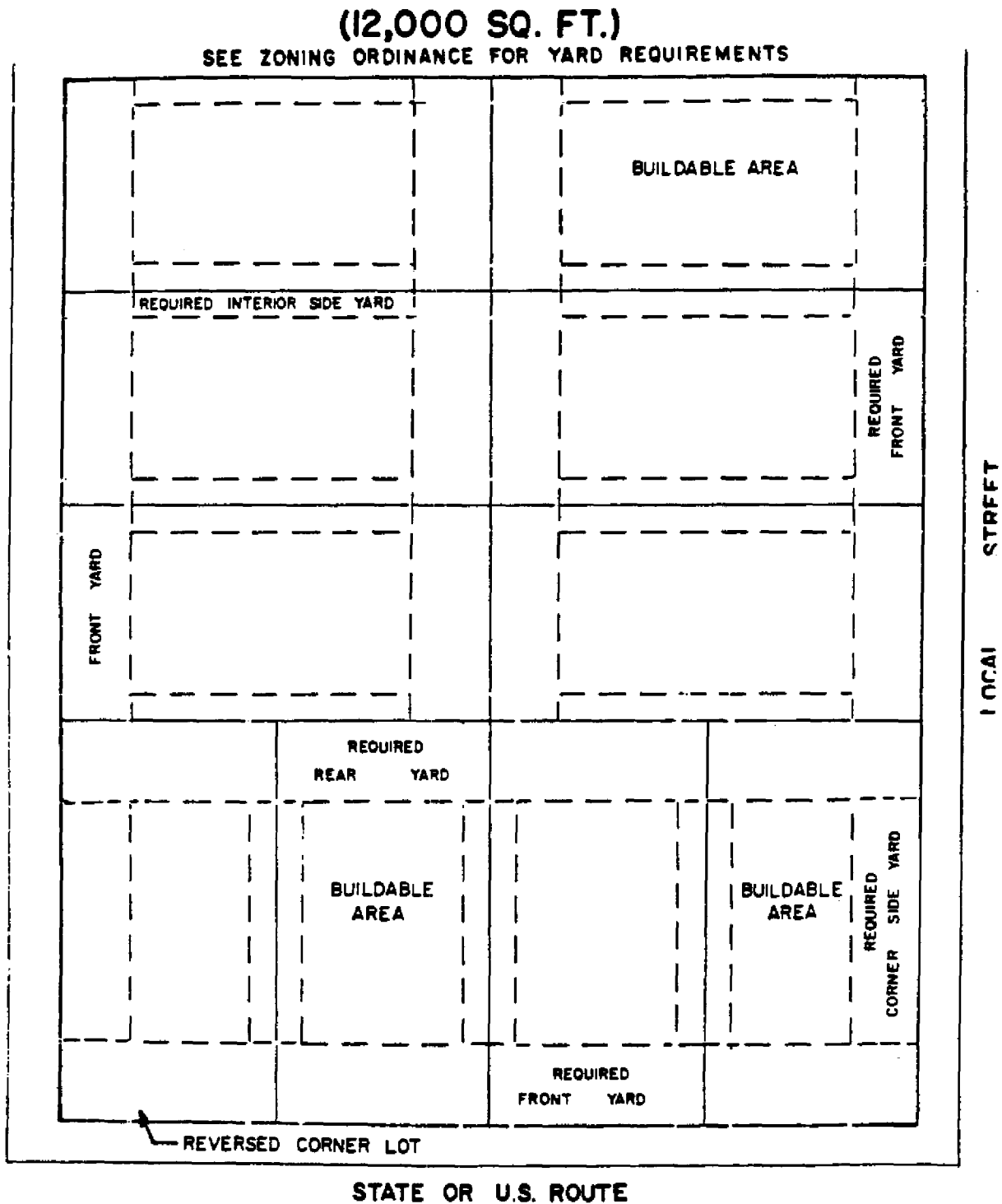

(Ord. 77-08, passed 6-28-77)

2005 S-9

§3. CORNER AND REVERSE CORNER SIDE YARDS - R-3 ONE-FAMILY RESIDENCE DISTRICT.

(10,000 SQ. FT.)

SEE ZONING ORDINANCE FOR YARD REQUIREMENTS

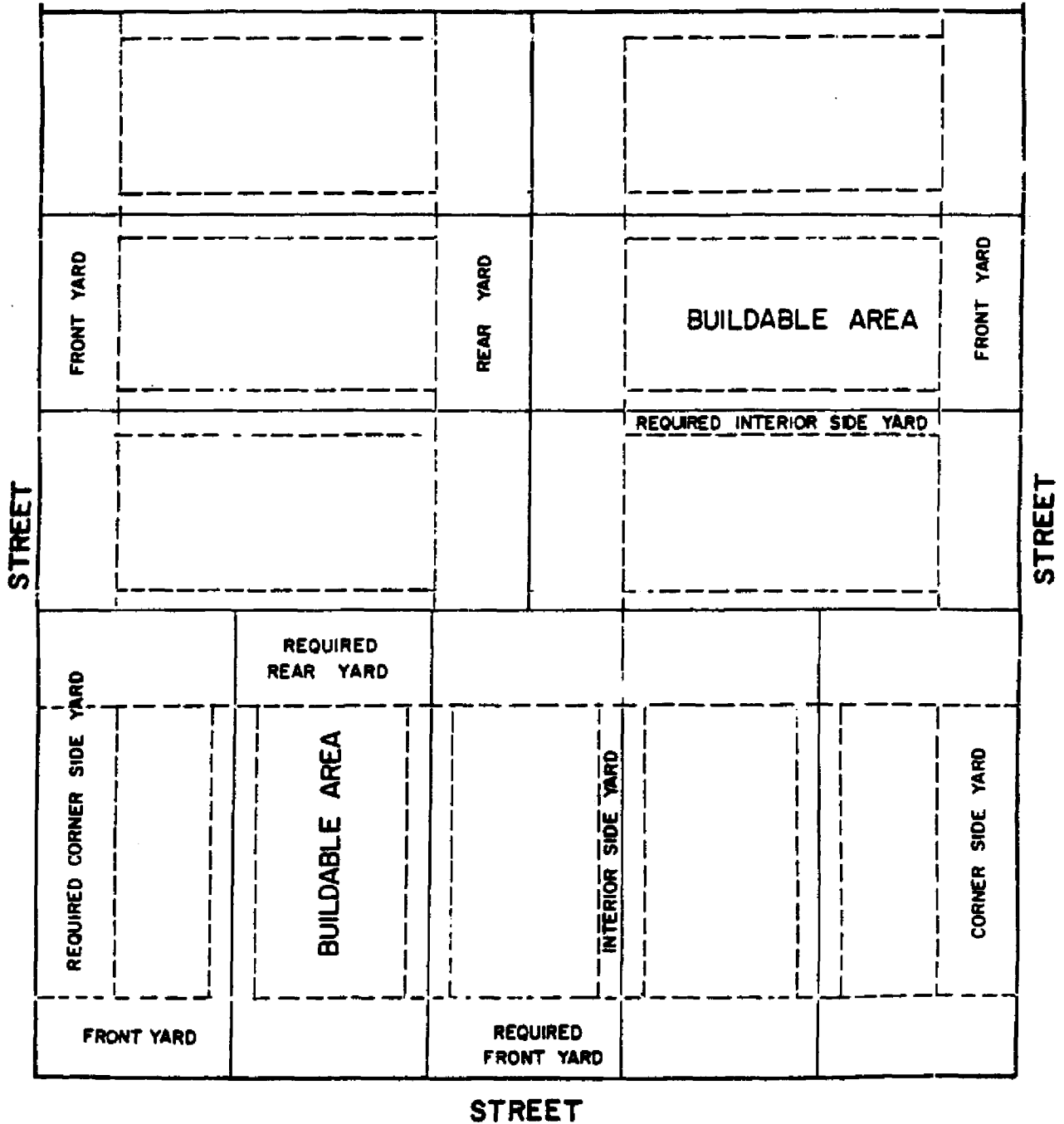

(Ord. 77-08, passed 6-28-77)

2005 S-9

§ 4. GOOD VISION CLEARANCE.

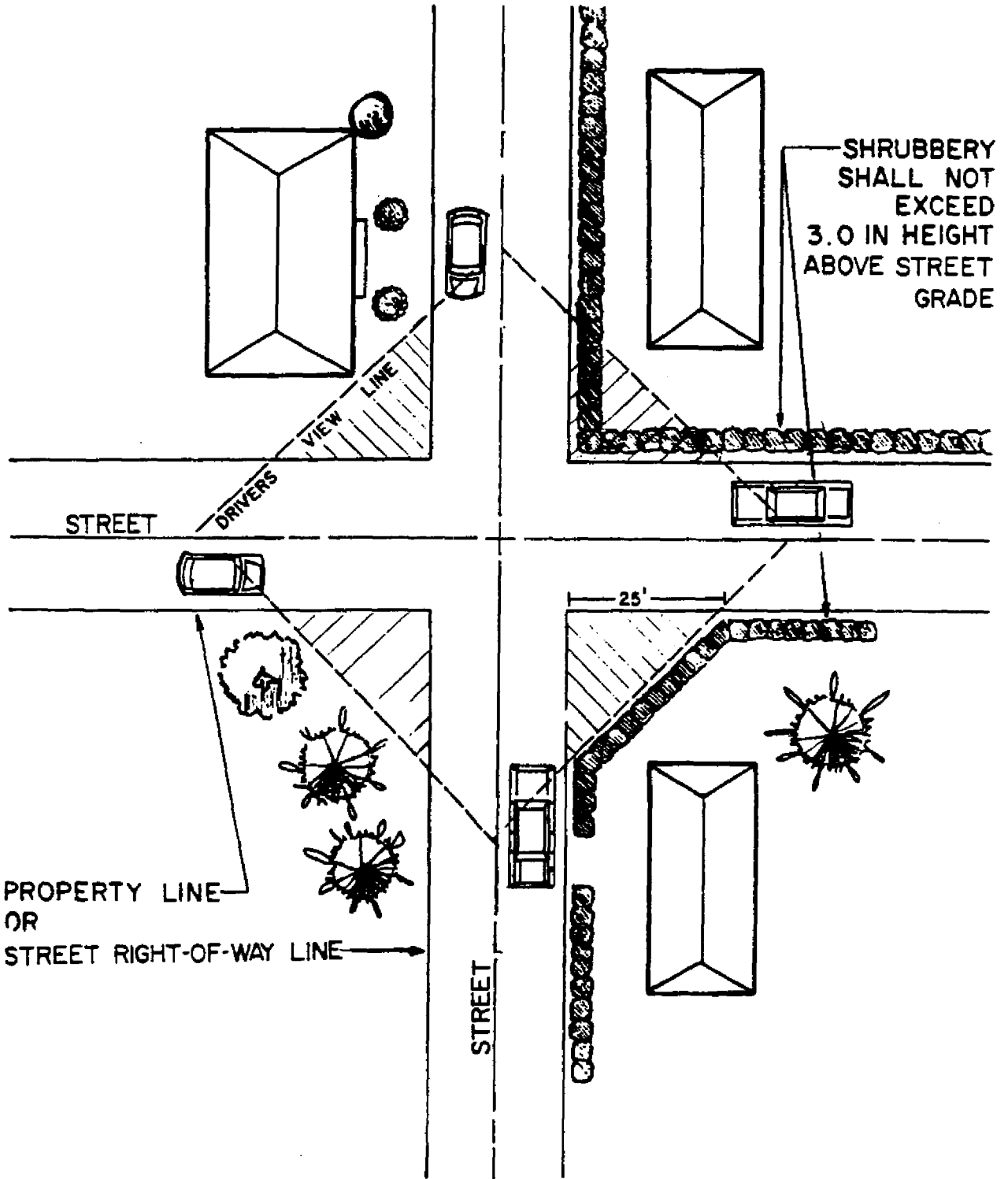

(Ord. 77-08, passed 6-28-77)

2005 S-9

§ 5. EXAMPLE OF RESIDENTIAL LOT TYPES.

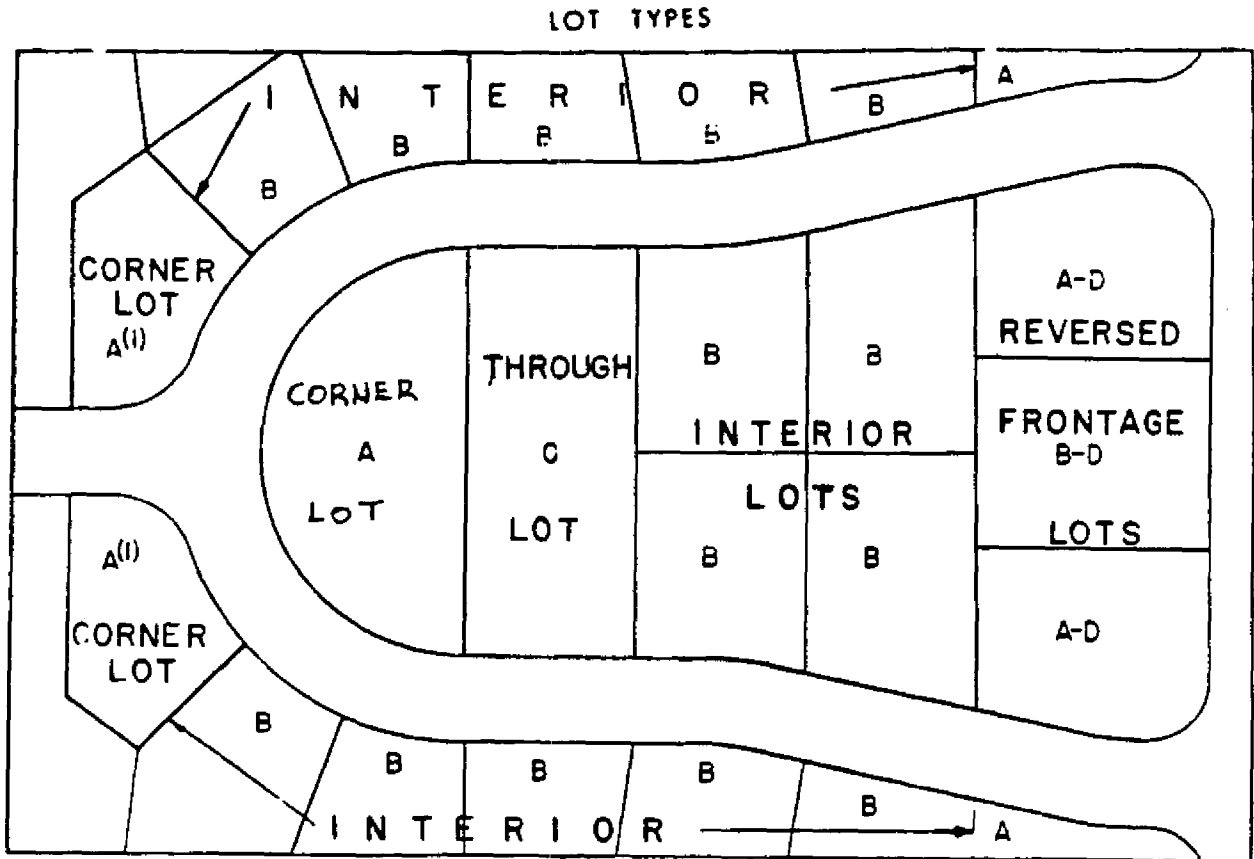

LOT TYPES

Corner Lot: A lot situated at the junction of and abutting on two (2) or more intersecting streets; or a lot at the point of deflection in alignment of a single street; the interior angle of which is one hundred and thirty (130) degrees or less. See lots marked A (1) in lot types diagram.

Interior Lot: A lot other than a corner lot with only one (1) frontage on a street other than an alley. See lots marked B in lot types diagram.

Through Lot: A lot having frontage on two (2) parallel or approximately parallel streets and which is not a corner lot. On a through lot both street lines shall be deemed front lot lines. See lot marked C in lot types diagram.

Reverse Corner Lot: A corner lot, the rear of which abuts upon the side of another lot, whether across an alley or not.

(Ord. 77-08, passed 6-28-77)

§ 6. CORNER LOT DIAGRAM.

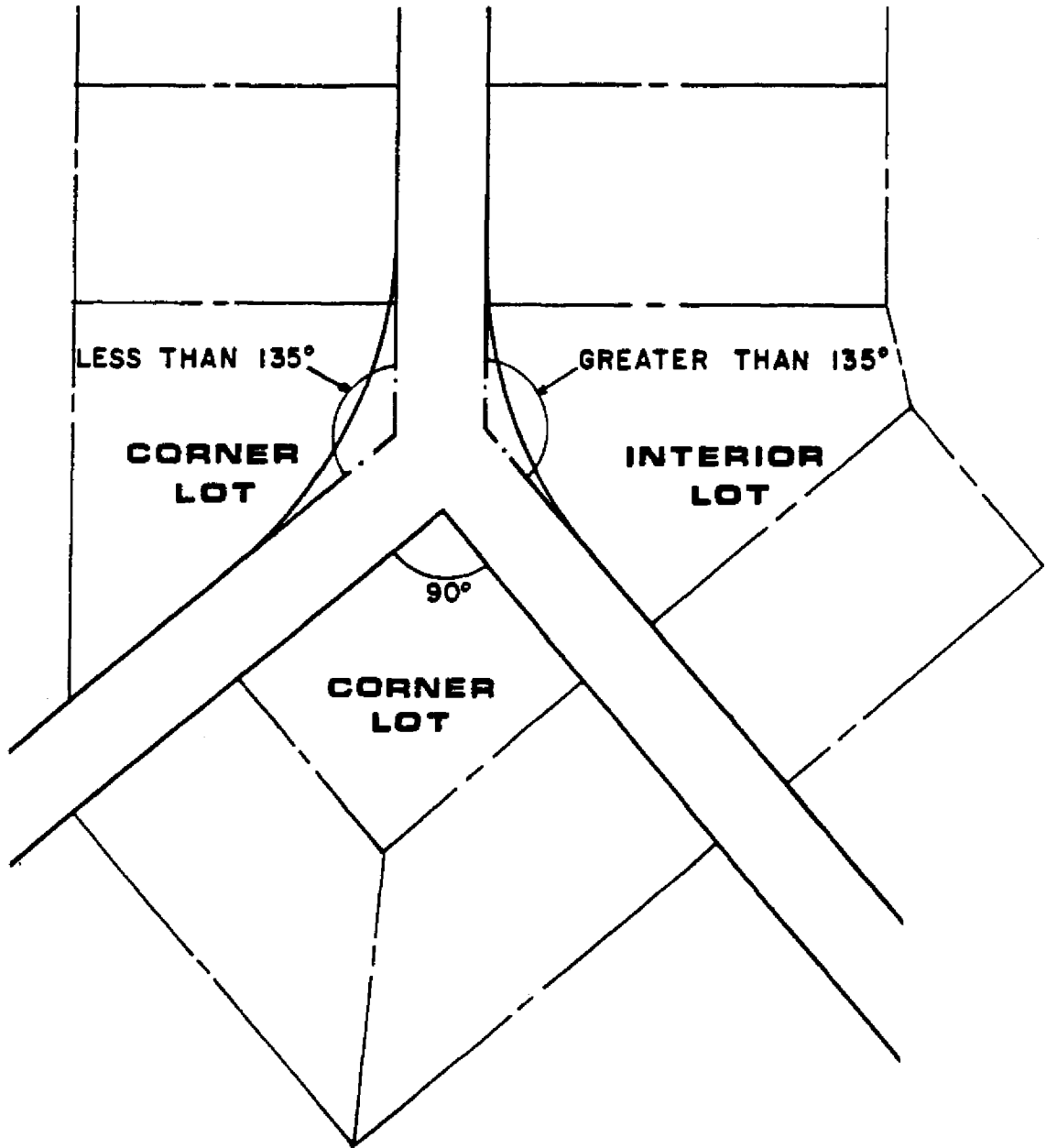

(Ord. 77-08, passed 6-28-77)

§ 7. LOT TYPES.

EXAMPLE OF RESIDENTIAL LOT TYPES

SEE ZONING ORDINANCE FOR YARD REQUIREMENTS

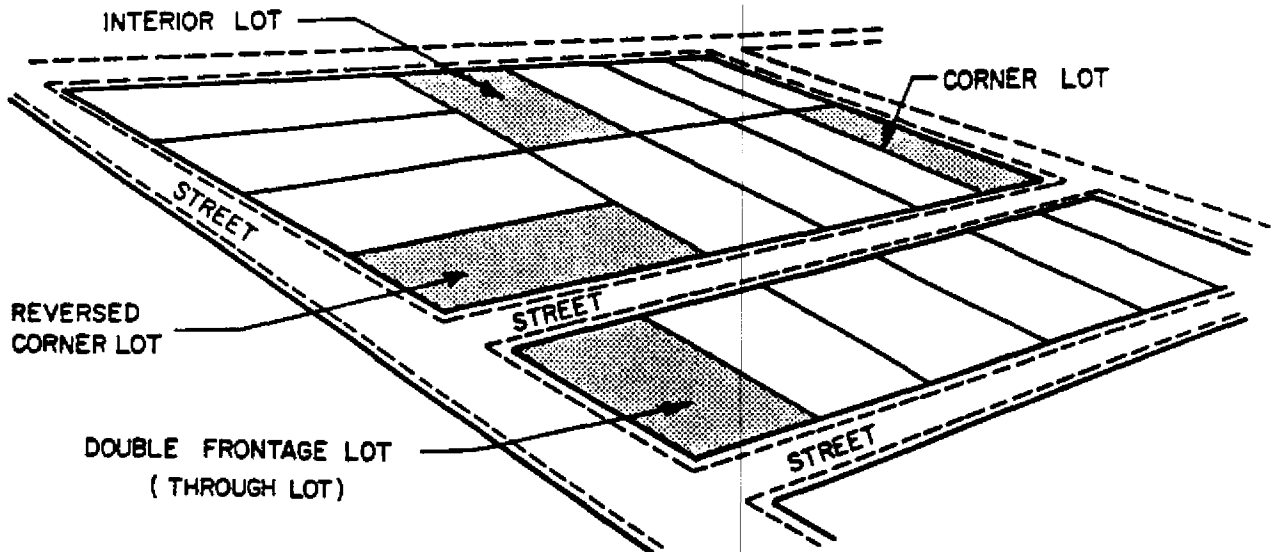
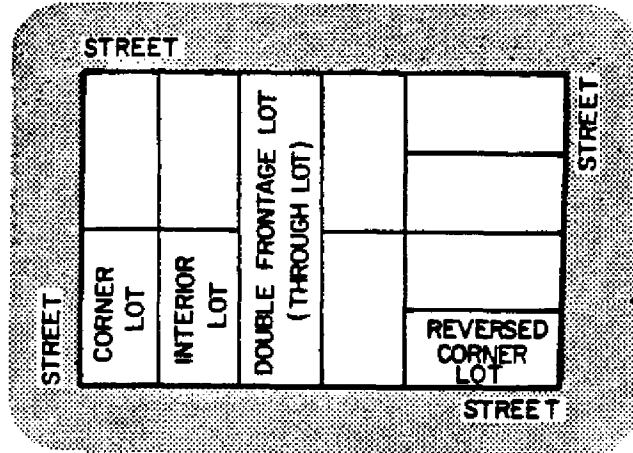

(Ord. 77-08, passed 6-28-77)

§ 8. LOT WIDTH AND LOT DEPTH EXPLAINED.

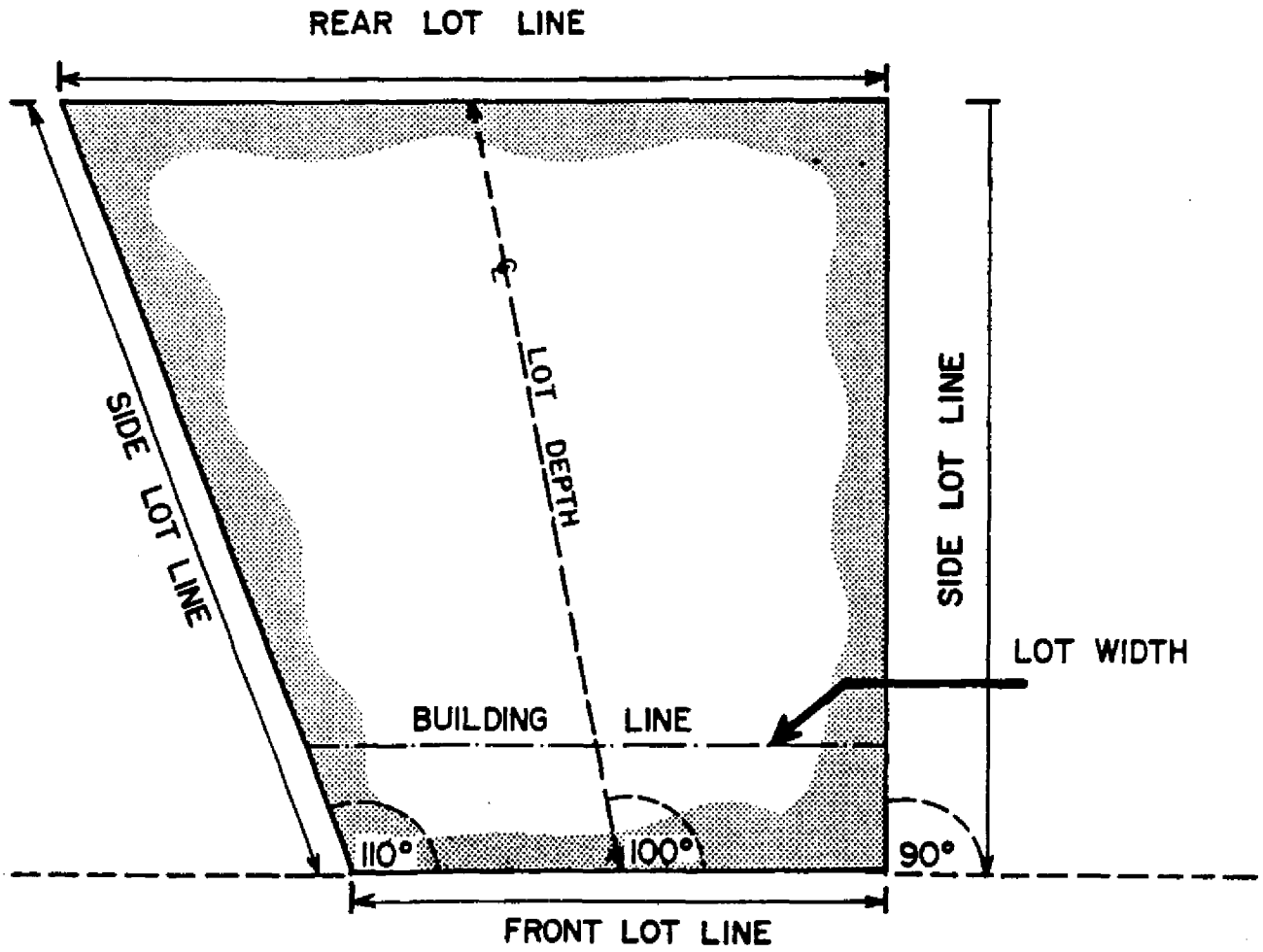

(Ord. 77-08, passed 6-28-77)

2005 S-9

