

APPENDIX B: CRESCENT STREET

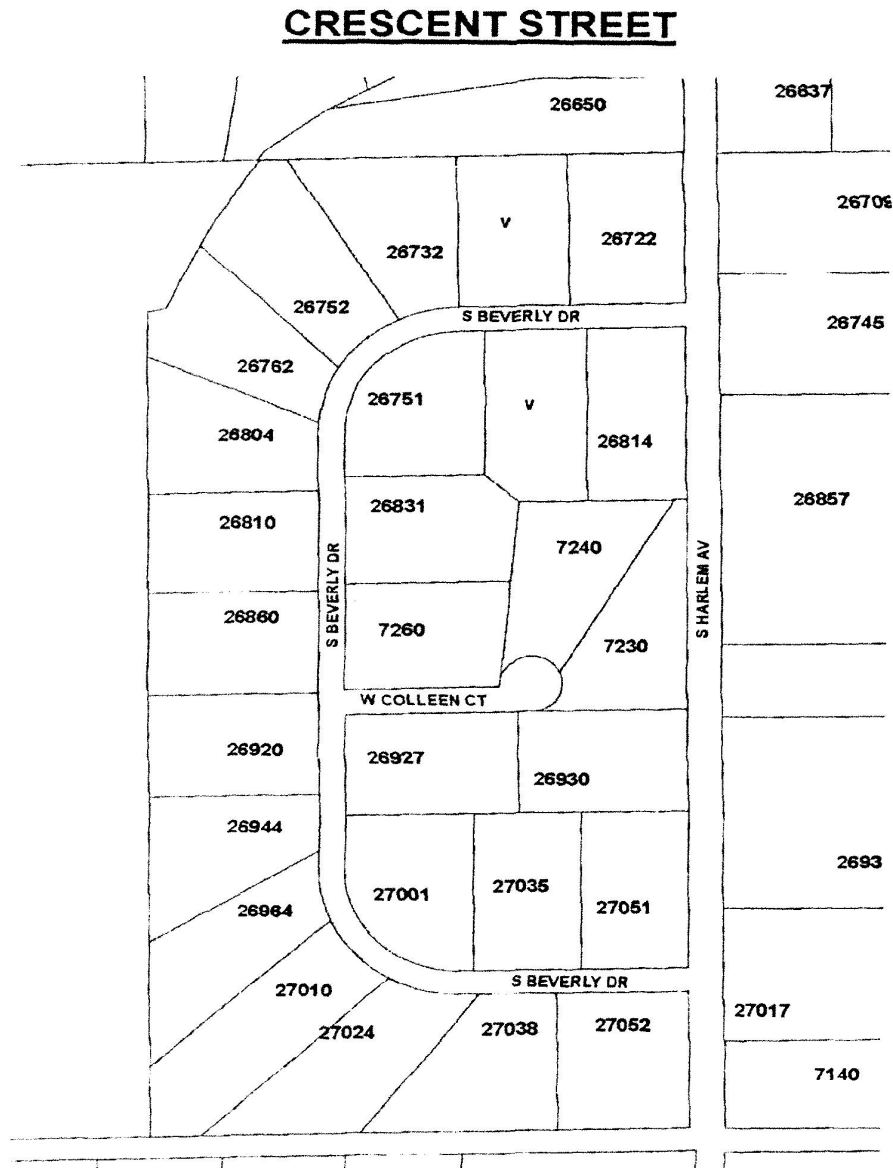

A crescent is designed so that a street has an entrance and exit at two points on the same collector street. Crescents are numbered consecutively from their beginning intersection to the ending intersection. Even though crescent street configurations are both north/south and east/west, the numbers are dependent on the direction of the collector street. In addressing a crescent, do not alternate addresses so that odd and even numbers will be located on the same side of the street. Address the crescent continuously in the same direction as the collector street. This is done to create a continuous flow of numbers. (Ord. 10-368, passed 11-18-2010)