

APPENDIX D: NORTH/SOUTH OR EAST/WEST STREET

NORTH/SOUTH OR EAST/WEST STREET

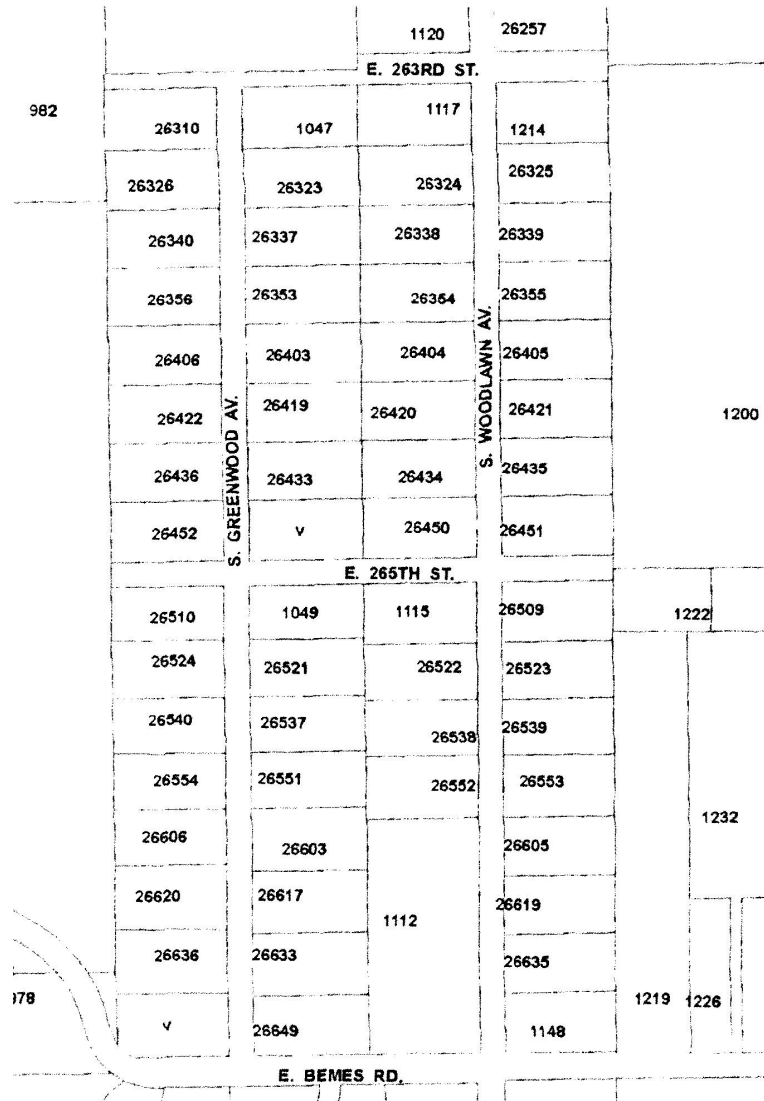

A north/south or east/west street is designed to provide vehicular access to abutting property in a grid system. North/south streets can be intersected by east/west streets. These streets are commonly found throughout the county in populated areas. The north and west side of the street shall have even numbers. The south and east side of the street shall be assigned odd numbers.
(Ord. 10-368, passed 11-18-2010)